

OREGON PUBLIC LAND CORNER REPORT / RESTORATION REPORT
Tillamook County Surveyor's Office

BOOK 8 206

SECTION: 30, 29, 31 and 32	TOWNSHIP: 1 South	RANGE: 10 West
COUNTY: Tillamook		DATE: 4/18/2024
CORNER DESIGNATION: The section corner common to sections 29, 30, 31 and 32, Township 1 South, Range 10 West; Willamette Meridian.		(Please check one)
		<input type="checkbox"/> Condition Report Only
		<input type="checkbox"/> Restoration
		<input checked="" type="checkbox"/> Rewitness
		<input type="checkbox"/> Unrecorded
		<input type="checkbox"/> Reset at surface
		<input type="checkbox"/> Referenced Out

Previous Rewitnesses, Restorations and Surveys, etc. BLM field notes volume: OR-R0053 PAGE 209 (1856), Rewitness Book 5, page 205 (1966), A-1781 (1969), Rewitness card #327(1978), B-786 (1978), B-819 (1978), A-5156 (1984), A-5161 (1984), A-5218 (1985).

History, condition, and sources

GLO (1856) BLM field notes volume: OR-R0053 page 209, A post was set to monument the Section corner along with four accessories. A 1 1/4" iron pipe of unknown origin found at location of original GLO position. Verification of corner position by John Carlich County Surveyor (Rewitness book 5 page 205, 1966) and added 3 new bearing trees. Subsequent Surveys in area are holding the 1 1/4" iron pipe as the original GLO position also. Rewitness card #327 (1978) found the 1 1/4" iron pipe and replaced it with a 2" iron pipe with a 3" Tillamook County Brass cap in 10" tile and concrete stamped "T.1S R.10W S30 S29 S31 S32 RS 287 1978" and added hat section post with yellow metal location tag. Survey B-3361 (2009) found the 3" Tillamook County brass cap in good condition and added four new accessories. In 2024 Tillamook County Surveyors office found a 3" Tillamook County brass cap in tile and concrete stamped as shown hereon. Previous record accessories are listed below.

Found: (Rewitness book 5, page 205, 1966) 24" hemlock N29°E 26.84'. (Rewitness card #327, 1978) 30" snag 15' tall 26.60' scribing visible. Now 2' diameter rotten mound.

Found: (Rewitness book 5, page 205, 1966) 30" hemlock N27°W 31.50'. (Rewitness card #327, 1978) 36" stump N43°W 29.16'.

Not Found: (unknown origin) 30" hemlock stump. (Rewitness card #327, 1978) N82°E 23.9' to center

Found: (Rewitness card #327, 1978) 4x4x6 post East 2.0'. Now found on ground West 3'

Found: (Rewitness card #327, 1978) hat section post SE. Found Now West 1.5'

Found: (unknown origin) Metal T fence post South 0.5'

New accessories set:

The monument was tied conventionally using double occupied GPS established control. The coordinates are provided here in WGS 84, Longitude and latitude.

Latitude: 45°26'56.70895"

Longitude: -123°56'52.52016"

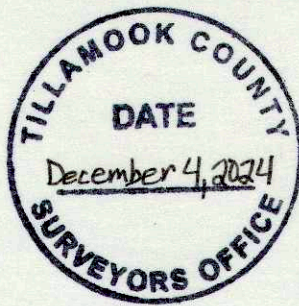

Pictures of Found Monuments:



Location: approximately 0.5 of a mile south of Oceanside sewer ponds ±150 from corner of logging road.

Tillamook County Surveyor office: 1510 3rd Street Suite C, Tillamook, OR. 97141

Party Chief: Travis Porter, Tillamook County Survey Office

Witnesses: Michael Rice P.L.S. 86926, Tillamook County Surveyor
Kael Pokliuha, Tillamook County Survey Tech

Notes: Digital images taken of monument and accessories.

SURVEYOR'S SEAL

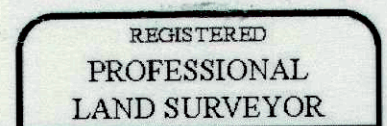

Michael R. Rice

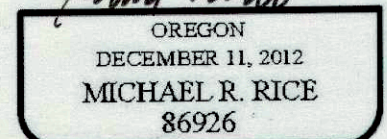

RENEWAL 12-31-2024